

RoHS

This products can apply to the SESO Doc NO. QA-3-04-005 of Environmental&Material Management Rules

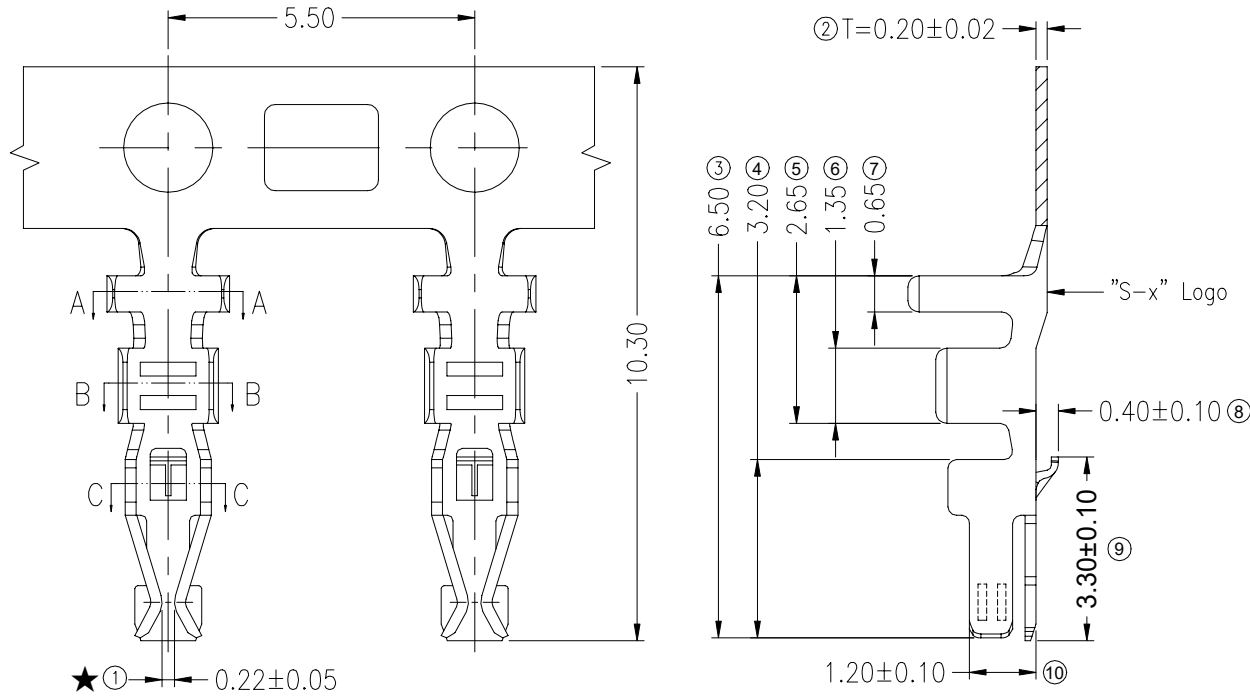

Specifications :

- Voltage rating: 250V AC / DC
- Current rating: 3A AC / DC
- Withstanding voltage: 800V AC/minute
- Temperature range: -40°C~+125°C
- Insulation resistance: ≥1000MΩ
- Contact resistance: <10mΩ
- After environmental testing: <20mΩ
- Used In SESO Housing: 2000H
- ★ "Represents special characteristics"



2000 T H-H XX X
① ② ③ ④ ⑤ ⑥

- ① Series No.2000
- ② Category: T-Terminal
- ③ Appearance type: H-High feet; Blank-Common feet
- ④ Material: H-Copper Alloy
- ⑤ Plating Style:

Y2-HDT Sn:1~3um(40~120u")
SN-Bright Tin Plating
Ni:0.75~3um(30~120u")
Sn:2~5um(80~200u")

- ⑥ Plating process:
Blank-Stamping before Plating;
B-Stamping After Plating

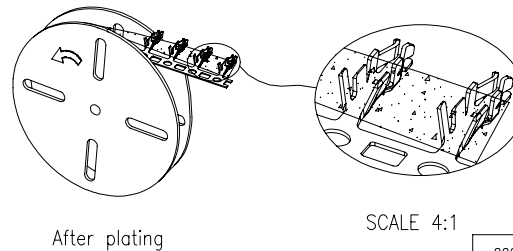
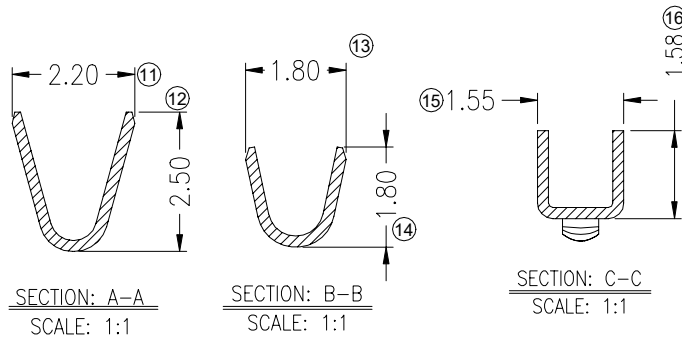

2000T-XXX	Copper Alloy	0.22~0.35mm ²	1.60mm(Max)	2.20	2.50	1.50	1.60	2000H
2000TH-HXXX	Copper Alloy	0.35~0.50mm ²	1.60mm(Max)	2.20	2.50	1.80	1.80	
PART NO	Material	Wire Size	Insulation O.D	DIM a	DIM b	DIM c	DIM d	Used In SESO Housing

						GENERAL TOLERANCE			
						.X ±0.35			
						.XX ±0.25			
						.XXX±0.15			
						X.' ±2'			
						PROJECT			
20240703	E1	/	Update Drawing Frame	Starry lin	Larry Yang				
DATE	REV	ECN NO.	DESCRIPTION	MODIFY	APPROVAL				

SMS 东莞市思索技术股份有限公司
Dongguan SESO Technology Co.,Ltd.

PART NO.				
2000TH-XXXX				
TITLE				
2.00mm Crimp Style Connectors				
UNIT	SCALE	SHEET	REV	NUMBER
mm	1:1	1/1	E1	CD

APPROVAL	CHECK	DRAWN	DATE
Jack Zhang	Larry Yang	Starry lin	2019/03/06

RoHS

This products can apply to the SESO Doc NO. QA-3-04-005 of Environmental&Material Management Rules

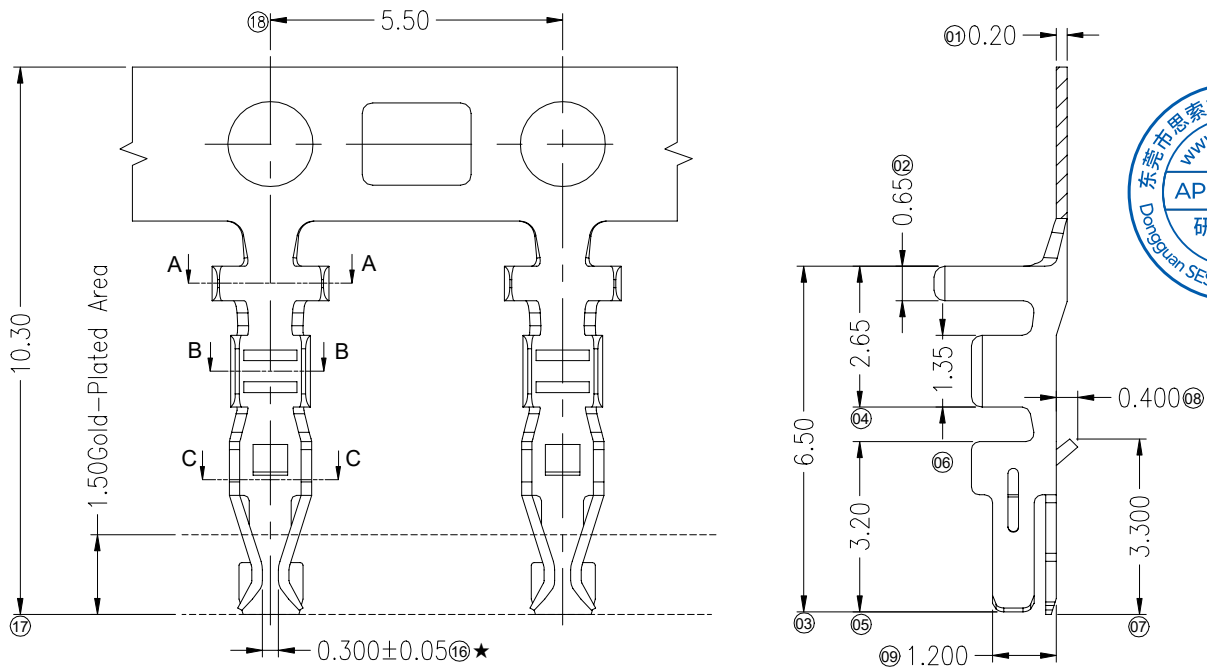

- Specifications :
- Voltage rating: 250V AC / DC
 - Current rating: 3A AC / DC
 - Withstanding voltage: 800V AC/minute
 - Temperature range: -40°C~+105°C
 - Insulation resistance: ≥1000MΩ
 - Contact resistance: ≤10mΩ
 - After environmental testing: ≤20mΩ
 - Used In SESO Housing: 2000H
 - "★" Critical dimension

2000 T X-P XX X-X
① ② ③ ④ ⑤ ⑥ ⑦

- ① Series No.2000
- ② Category: T-Terminal
- ③ Appearance type: Blank-Ordinary; H-High feet; L-Low feet
- ④ Material: P-Phosphor bronze
- ⑤ Plating Code: G01-Contact Gold 1u"
G03-Contact Gold 3u"
SN-Bright Tin Plating
- ⑥ Plating Method : Blank-Stamping before Plating
- ⑦ Special No.

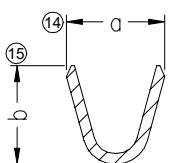

SECTION: A-A
SCALE: 1:1

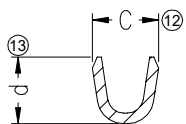

SECTION: B-B
SCALE: 1:1

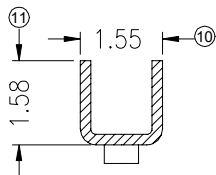

SECTION: C-C
SCALE: 1:1

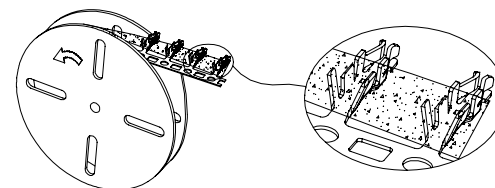

After plating SCALE 4:1

2000TH-PXXX	Phosphor bronze	AWG#20~22 (0.5~0.35mm ²)	1.50mm(Max)	2.20	2.50	1.80	1.80
2000T-PXXX		AWG#22~24 (0.35~0.22mm ²)	1.50mm(Max)	2.20	2.50	1.50	1.60
2000TL-PXXX		AWG#26~30 (0.128~0.05mm ²)	1.00mm(Max)	1.85	1.85	1.25	1.25
P/N	Material	Wire Size	Insulation O.D	DIM a	DIM b	DIM c	DIM d

20230614	G1	/	Update Drawing Frame	Starry lin	Larry Yang
20220420	G	ER20220418003	Change low foot pressure line specification	Xuexiaolong	Robing
20200319	F	EN20200319001	Update Drawing Frame	Wzbin	Robing
DATE	REV	ECN NO.	DESCRIPTION	MODIFY	APPROVAL

GENERAL TOLERANCE	
.X	±0.30
.XX	±0.20
.XXX	±0.10
X.' ±2'	
PROJECT	

SMS 东莞市思索技术股份有限公司
Dongguan SESO Technology Co.,Ltd.

APPROVAL	CHECK	DRAWN	DATE
Jack Zhang	Larry Yang	Starry lin	2023/04/26

PART NO. 2000TX-PXXX				
TITLE 2.00mm Crimp Style Connectors				
UNIT	SCALE	SHEET	REV	NUMBER
mm	1:1	1/1	G1	CD

RoHS

This products can apply to the SESO Doc NO. QA-3-04-005 of Environmental&Material Management Rules

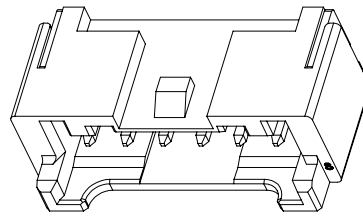
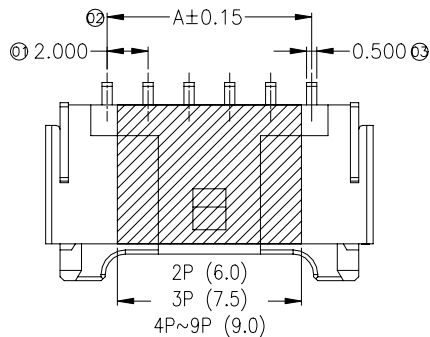

- Specifications :
- Voltage rating: 250V AC / DC
 - Current rating: 3A AC / DC
 - Withstanding voltage: 800V AC/minute
 - Temperature range: -40°C~+125°C
 - Insulation resistance: >1000MΩ
 - Contact resistance: <10mΩ
 - After environmental testing: <20mΩ
 - "★" Critical dimension
 - Material(Pin): Brass
 - Material(Solder Tabs): Brass
 - Mates With SESO Housing: 2000H/2019H

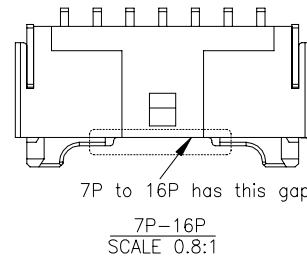
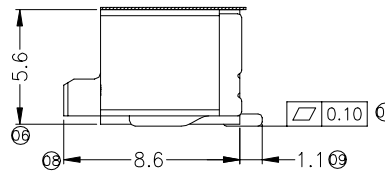
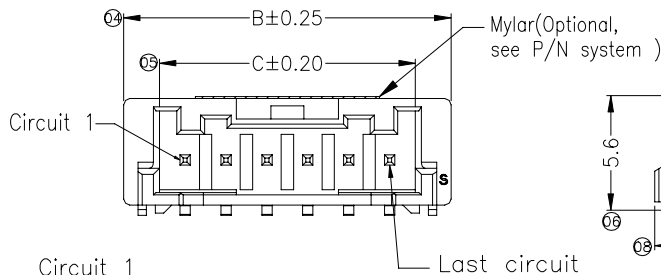

P/N system:

2000 W R S-XX X-XX SW XX X XX
① ② ③ ④ ⑤ ⑥ ⑦ ⑧ ⑨ ⑩ ⑪

- ① Series No.:2000
- ② Category: W-WAFER
- ③ Connector type: R-Right Angle 90°
- ④ Mounting type: S-SMT
- ⑤ Row No.-Pin No per row: XX-02P~16P
- ⑥ Special No.
- ⑦ Material: 9T-PA9T 94V-0; LP-LCP 94V-0
- ⑧ Plating code: SW-Matte Tin GW3-Contact point gold 3u"
- ⑨ Color : Blank-Natural Color ; BK-Black Color
- ⑩ Packing: 02~09P With Mylar;
10~16P Without Mylar
R-Reel ,02~09P Without Mylar
- ⑪ Cover tape type: Blank-Adhesive ; RQ-Heat sealing

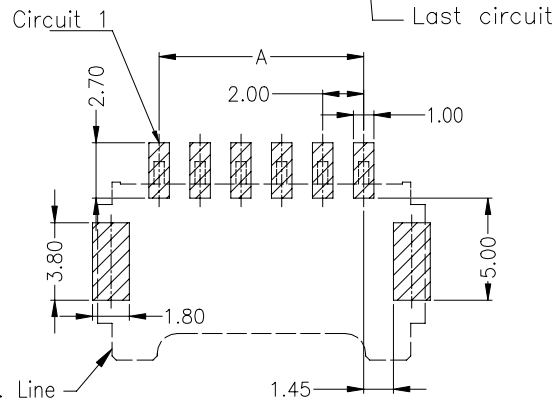

Recommended P.C.B Layout
General Tolerance±0.05

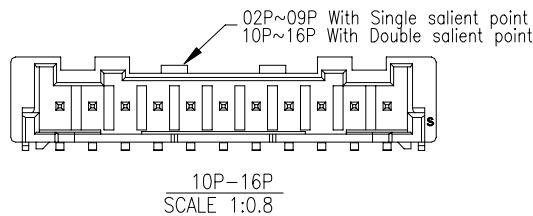
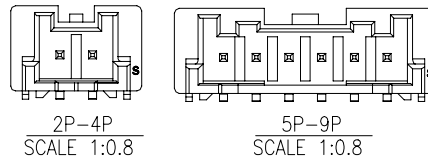

Poles	Dimensions (mm)			Poles	Dimensions (mm)		
	A	B	C		A	B	C
02	2.00	8.00	4.50	10	18.00	24.00	20.50
03	4.00	10.00	6.50	11	20.00	26.00	22.50
04	6.00	12.00	8.50	12	22.00	28.00	24.50
05	8.00	14.00	10.50	13	24.00	30.00	26.50
06	10.00	16.00	12.50	14	26.00	32.00	28.50
07	12.00	18.00	14.50	15	28.00	34.00	30.50
08	14.00	20.00	16.50	16	30.00	36.00	32.50
09	16.00	22.00	18.50				

2023/06/14	N1		Update Drawing Frame	Starry lin	Larry Yang	东莞市思索技术股份有限公司 Dongguan SESO Technology Co.,Ltd.				PART NO. 2000WRS-XX-XXSWXXX					
2022/09/09	N		Added half gold plated 3U "specification	Xuexiaolong	Larry					TITLE 2.00mm Crimp Style Connector					
2020/09/23	M	EN120200923001	Add P/N for heat sealing cover tape	TengMin	Harvey Yan	APPROVAL	CHECK	DRAWN	DATE	UNIT SCALE SHEET REV NUMBER					
DATE	REV	ECN NO.	DESCRIPTION	MODIFY	APPROVAL	PROJECT	Jack Zhang	Larry Yang	Starry lin	2014/05/05	mm	1:1	1/1	N1	CD

RoHS

This products can apply to the SESO Doc NO. QA-3-04-005 of Environmental&Material Management Rules

Specifications :

- Voltage rating: 250V AC / DC
- Current rating: 3A AC / DC
- Withstanding voltage: 800V AC/minute
- Temperature range: -40°C~+125°C
- Insulation resistance: >1000MΩ
- Contact resistance: <10mΩ
- After environmental testing: <20mΩ
- "★" Critical dimension
- Material(Pin): Brass
- Material(Solder Tabs): Brass
- Mates With SESO Housing: 2000H/2019H

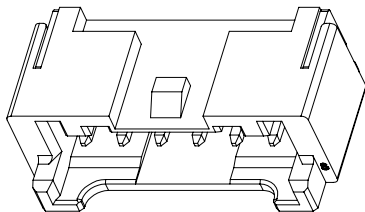
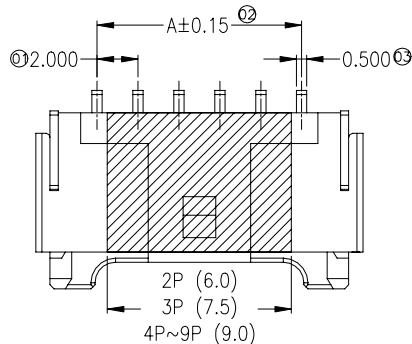

2000 W R S-XX X-XX SW XX X -S

① ② ③ ④ ⑤ ⑥ ⑦ ⑧ ⑨ ⑩

- ① Series No.:2000
- ② Category: W-WAFER
- ③ Connector type: R-Right Angle 90°
- ④ Mounting type: S-SMT
- ⑤ Row No.-Pin No per row: XX-02P~05P
- ⑥ Special No.:Blank-common
- ⑦ Material: 9T -PA9T 94V-0; LP -LCP 94V-0
- ⑧ Plating code: SW- Matte Tin
GW3-Contact point gold 3u"
- ⑨ Color : Blank-Natural Color ; BK-Black Color
- ⑩ Packing: 02~09P With Mylar;
10~16P Without Mylar
R-Reel ,02~09P Without Mylar

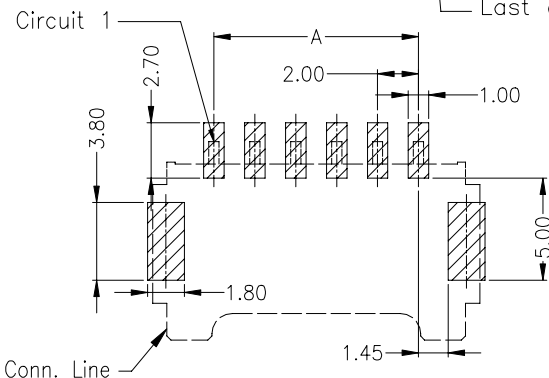
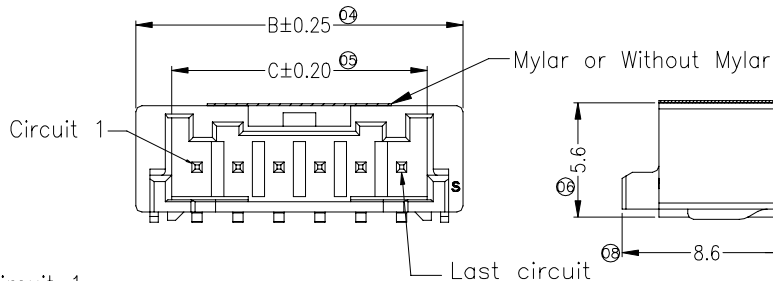

Recommended P.C.B Layout
General Tolerance±0.05

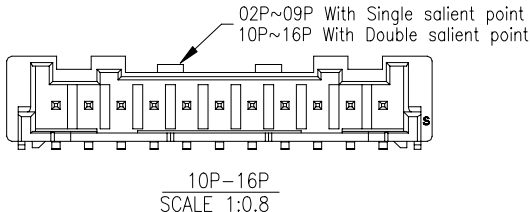
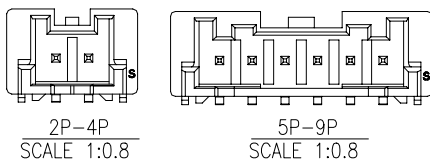

Poles	Dimensions (mm)			Poles	Dimensions (mm)		
	A	B	C		A	B	C
02	2.00	8.00	4.50	10	18.00	24.00	20.50
03	4.00	10.00	6.50	11	20.00	26.00	22.50
04	6.00	12.00	8.50	12	22.00	28.00	24.50
05	8.00	14.00	10.50	13	24.00	30.00	26.50
06	10.00	16.00	12.50	14	26.00	32.00	28.50
07	12.00	18.00	14.50	15	28.00	34.00	30.50
08	14.00	20.00	16.50	16	30.00	36.00	32.50
09	16.00	22.00	18.50				

DATE	REV	ECN NO.	DESCRIPTION	MODIFY	APPROVAL	PROJECT
2023/06/14	M1		Update Drawing Frame	Starry lin	Larry Yang	GENERAL TOLERANCE
2022/09/09	M		Added half gold plated 3U "specification	xuexiaolong	Larry Yang	.X ±0.30
2020/03/20	L	EN20200319001	Update Drawing Frame	Wzbin	Robing	.XX ±0.20
						.XXX±0.10
						X.' ±2'
						PROJECT

SMS 东莞市思索技术股份有限公司
Dongguan SESO Technology Co.,Ltd.

APPROVAL	CHECK	DRAWN	DATE
Jack Zhang	Larry Yang	Starry lin	2014/05/05

PART NO.				
2000WRS-XX-XXSWXXX-S				
TITLE				
2.00mm Crimp Style Connector				
UNIT	SCALE	SHEET	REV	NUMBER
mm	1:1	1/1	M1	CD

RoHS

This products can apply to the SESO Doc NO. QA-3-04-005 of Environmental&Material Management Rules

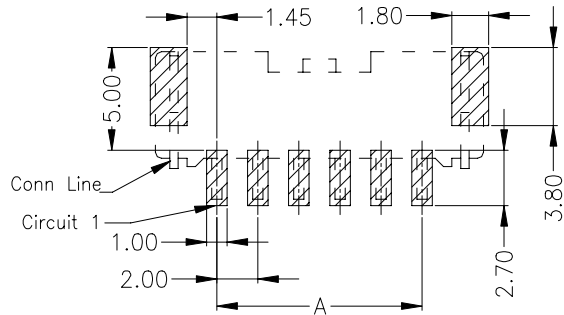
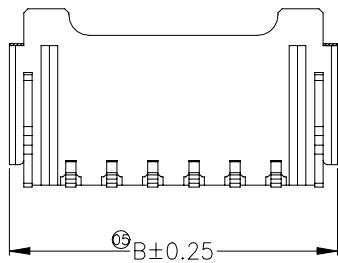
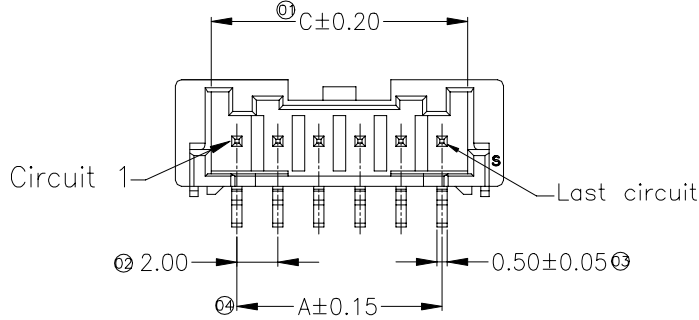

Recommended P.C.B Layout
General Tolerance±0.05

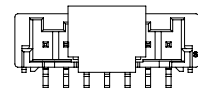

CAP(9~16P With CAP)
SCALE 1:2



Mylar(2~8P With Mylar)
SCALE 1:2

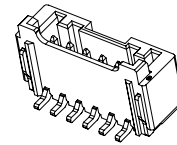

SCALE 1:2

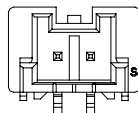
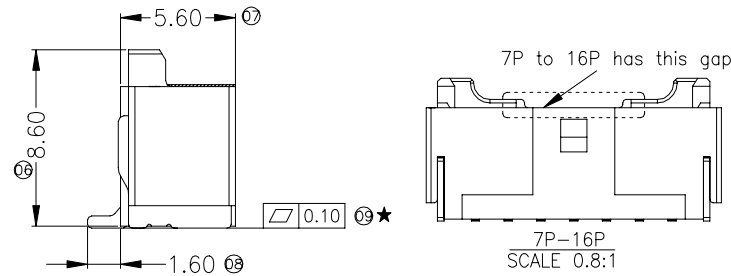

2P-4P
SCALE 0.8:1

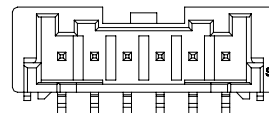

5P-9P
SCALE 0.8:1

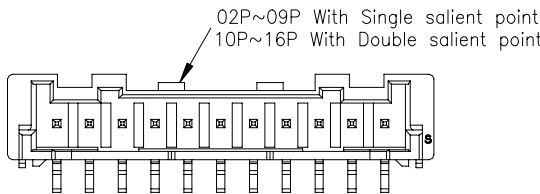

10P-16P
SCALE 0.8:1

Specifications :

- Voltage rating: 250V AC / DC
- Current rating: 3A AC / DC
- Withstanding voltage: 800V AC/minute
- Temperature range: -40°C~+125°C
- Insulation resistance: ≥1000MΩ
- Contact resistance: ≤10mΩ
- After environmental testing: ≤20mΩ
- Material(Pin): Brass
- Material(Solder Tabs): Brass
- Mates With SESO Housing: 2000H/2019H
- "★" Critical dimension

2000	W	V	S-XX	X-XX	SW	XX	X	XX
①	②	③	④	⑤	⑥	⑦	⑧	⑨

- ① Series No.:2000
- ② Category:W-WAFER
- ③ Connector type:V-Stright 180°
- ④ Mouting type: S-SMT
- ⑤ Pin number: XX-02P~16P
- ⑥ Plug the Pin & Special No.:
Blank-With Mylar , C-9-16P With CAP
- ⑦ Material: 9T -PA9T 94V-0
LP -LCP 94V-0
- ⑧ Plating Code:SW-Matte Tin ; G03-Contact Area Gold 3u"
- ⑨ Color : Blank-Natural ; BK-Black
- ⑩ Packing: Blank-Reel ,2~8P With Mylar
R-Reel ,Without Mylar&CAP
- ⑪ Cover tape type: Blank-Adhesive ; RQ- Heat sealing

Poles	Dimensions (mm)			Poles	Dimensions (mm)		
	A	B	C		A	B	C
02	2.00	8.00	4.50	10	18.00	24.00	20.50
03	4.00	10.00	6.50	11	20.00	26.00	22.50
04	6.00	12.00	8.50	12	22.00	28.00	24.50
05	8.00	14.00	10.50	13	24.00	30.00	26.50
06	10.00	16.00	12.50	14	26.00	32.00	28.50
07	12.00	18.00	14.50	15	28.00	34.00	30.50
08	14.00	20.00	16.50	16	30.00	36.00	32.50
09	16.00	22.00	18.50				

2023/06/14	K1		Update Drawing Frame	starry lin	Larry Yang
2022/02/21	K	EN20211006001	Change the suction cover structure	Xue	John Yang
2021/02/27	J	EN120210227001	Add P/N for heat sealing cover tape and plating code	TengMin	John Yang
DATE	REV	ECN NO.	DESCRIPTION	MODIFY	APPROVAL

GENERAL TOLERANCE	
.X	±0.30
.XX	±0.20
.XXX	±0.10
X.' ±2'	
PROJECT	

SMS 东莞市思索技术股份有限公司
Dongguan SESO Technology Co.,Ltd.

APPROVAL	CHECK	DRAWN	DATE
Jack Zhang	Larry Yang	starry lin	2018/05/31

PART NO. 2000WVS-XXX-XXSWXXXX				
TITLE 2.00mm Crimp Style Connector				
UNIT	SCALE	SHEET	REV	NUMBER
mm	1:1	1/1	K1	CD

RoHS

This products can apply to the SESO Doc NO. QA-3-04-005 of Environmental&Material Management Rules

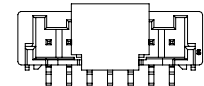
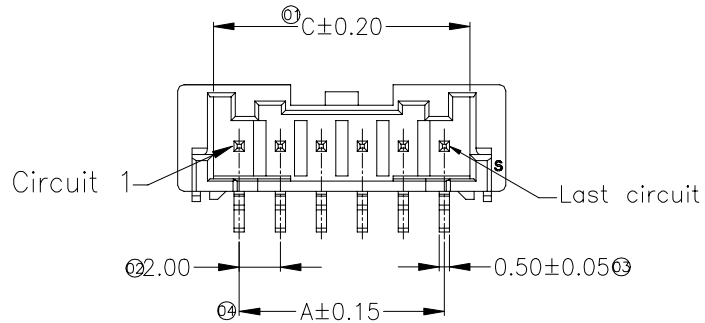

CAP(9~16P With CAP)
SCALE 1:2

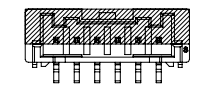

Mylar(2~8P With Mylar)
SCALE 1:2

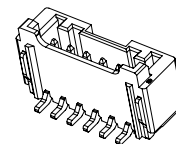

SCALE 1:2

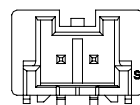
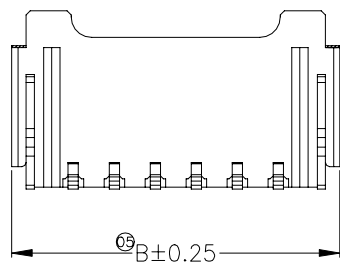
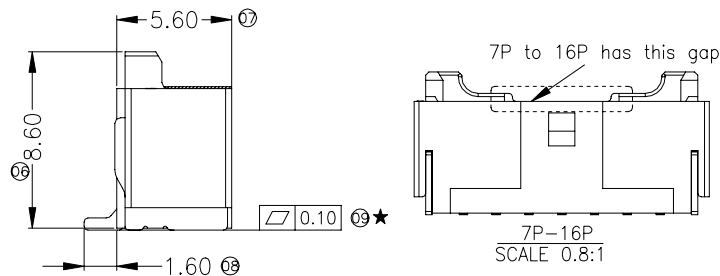

2P-4P
SCALE 0.8:1

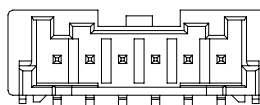

5P-9P
SCALE 0.8:1

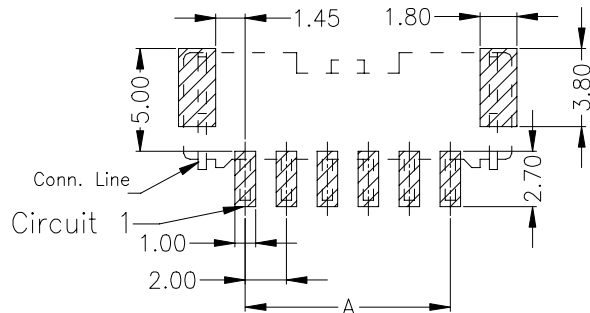

Recommended P.C.B Layout
General Tolerance±0.05

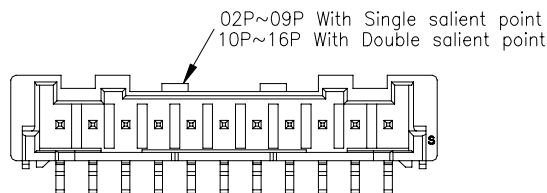

10P-16P
SCALE 0.8:1

Specifications :

- Voltage rating: 250V AC / DC
- Current rating: 3A AC / DC
- Withstanding voltage: 800V AC/minute
- Temperature range: -40°C~+125°C
- Insulation resistance: ≥1000MΩ
- Contact resistance: ≤10mΩ
- After environmental testing: ≤20mΩ
- Material(Pin): Brass
- Material(Solder Tabs): Brass
- Mates With SESO Housing: 2000H/2019H
- " ★ " Critical dimension

2000 W V S-XX X-9T SW XX X-S
① ② ③ ④ ⑤ ⑥ ⑦ ⑧ ⑨ ⑩

- ① Series No.:2000
- ② Category: W-WAFER
- ③ Connector type: V-Stright 180°
- ④ Mouting type: S-SMT
- ⑤ Pin number: XX-02P~16P
- ⑥ Plug the Pin & Special No.
- ⑦ Material: 9T -PA9T 94V-0
- ⑧ Plating Code: SW-Matte Tin
- ⑨ Color : Blank-Natural ; BK-Black
- ⑩ Packing: Blank-Reel ,2~8P With Mylar
9-16P With CAP
R-Reel ,Without Mylar&CAP

Poles	Dimensions (mm)			Poles	Dimensions (mm)		
	A	B	C		A	B	C
02	2.00	8.00	4.50	10	18.00	24.00	20.50
03	4.00	10.00	6.50	11	20.00	26.00	22.50
04	6.00	12.00	8.50	12	22.00	28.00	24.50
05	8.00	14.00	10.50	13	24.00	30.00	26.50
06	10.00	16.00	12.50	14	26.00	32.00	28.50
07	12.00	18.00	14.50	15	28.00	34.00	30.50
08	14.00	20.00	16.50	16	30.00	36.00	32.50
09	16.00	22.00	18.50				

2023/06/14	J1		Update Drawing Frame	starry lin	Larry Yang
2022/02/21	J	EN20211006001	Change the suction cover structure	Xue	John Yang
2020/03/19	I	EN20200319001	Update Drawing Frame	Wzbin	Robing
DATE	REV	ECN NO.	DESCRIPTION	MODIFY	APPROVAL

GENERAL TOLERANCE	
.X	±0.30
.XX	±0.20
.XXX	±0.10
X.' ±2'	
PROJECT	

SMS 东莞市思索技术股份有限公司
Dongguan SESO Technology Co.,Ltd.

APPROVAL	CHECK	DRAWN	DATE
Jack Zhang	Larry Yang	starry lin	2018/05/31

PART NO.				
2000WVS-XXX-9TSWXXX-S				
TITLE				
2.00mm Crimp Style Connector				
UNIT	SCALE	SHEET	REV	NUMBER
mm	1:1	1/1	J1	CD